

# MAROONDAH ORCHID SOCIETY

## INCORPORATED

# MONTHLY NEWS LETTER

Lycastes are orchids of the  
New World Tropics and Subtropics



Lycaste Club Emblem

Volume : 46 - Issue : 1

**Next Meeting: Friday – 17 February 2023**

**Venue: NEW Venue (Please see map below)**  
**St. Timothy's**  
**21 Stevens Road, Vermont.**  
**(Melway, Map 62 Ref.G3)**

### **ITEM OF THE EVENING: Terry Poulton – Cymbidiums the Poulton Way**

<b>Time:</b>	<b>8.00PM</b>
<b>Venue:</b>	<b>New venue at St Timothy's (see map below).</b>
<b>Topical Chat:</b>	<b>Summer Care and Growth</b>
<b>Supper:</b>	<b>Please bring a plate</b>
<b>Special Effort:</b>	<b>Tickets at door \$1.00 or 3 for \$2.00</b>
<b>Sales Table:</b>	<b>Pots, stakes, labels and hangers – C. Luth</b>

## President's Report

And a new year begins! What were your highs and lows in growing orchids in 2022? What did you learn from those experiences? I trust that the program the Committee sets for 2023 will bring you a better understanding of the growing of your current and, possibly, new genera plants.

I look forward to seeing the plants benched at our monthly meetings and also the various in-house shows that the Committee arranges in 2023.

Some of you will have progressed from the Novice Section to Intermediate and others from Intermediate to the Open Section – Congratulations!

**Please be aware that we will no longer be holding our monthly Club Meetings in the same hall as in past years. In future all meetings will be held in a large room in the School building – see separate notice and diagram for the new location.**

Although Government restrictions regarding Covid safety are minimal, we welcome you if you still wish to sanitise your hands and wear a mask. For members who have not been in the best of health over recent months I wish you a speedy recovery. I look forward to seeing you at the 2023 Club Meetings.

Ron Coleman

**Please note:** If you have changed your contact details such as phone, email address or home address can you please contact Edith Yu-Chan (M) 0411 378 096 so we can update our records.

Thank you!

## New Location at St. Timothy's

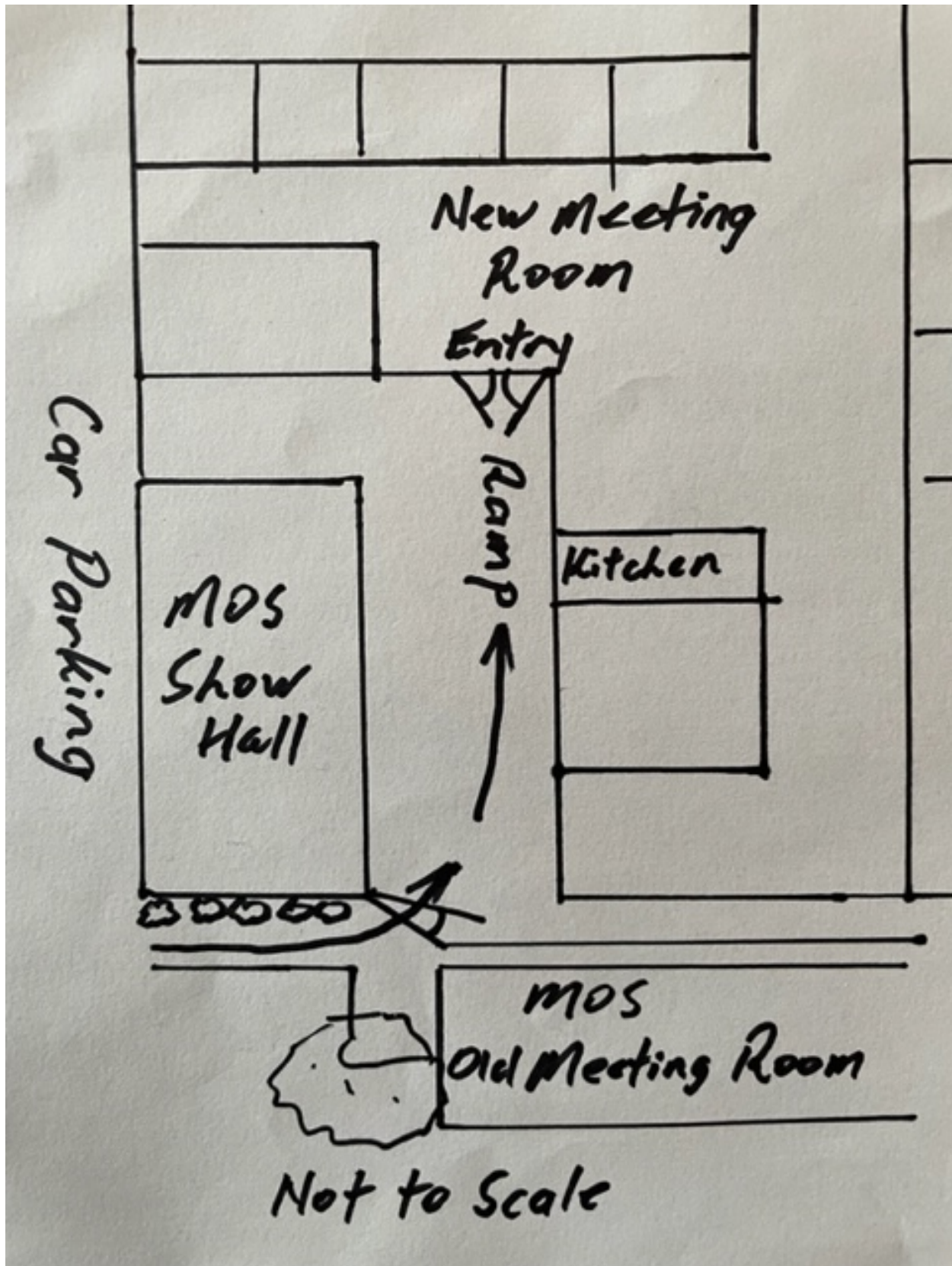

**M.O.S. Inc. Patron:** David Cannon

**Life Members:** The late Frank Date, Jim Foster-Johnson, David Cannon, Alan & Nancy Cockram, Dieter Weise, The late Barry Robinson, Susanne Redpath, Max Bomford, Cheryl Luth, G Moffat.

**Current M.O.S. Inc. Committee:**

<b>President</b>	Ron Coleman (M) 0477 311 188
<b>Vice Presidents:</b>	David Cannon (M) 0418 394 282 Vacant
<b>Secretary:</b>	Leo Orland (M) 0419 884 492 Email: <a href="mailto:leoorland@totalfundraising.com.au">leoorland@totalfundraising.com.au</a>
<b>Treasurer:</b>	Graeme Moffat (H) 9726 5793
<b>Committee</b>	Leanne Le (M) 0416 818 290 Daniel Tung Jim Foster-Johnson (M) 0412 366 686 Edith Yu-Chan (M) 0411 378 096 Heather Coleman Claudia Ng
<b>Membership Secretary:</b>	Edith Yu-Chan
<b>Newsletter:</b>	Leo Orland
<b>Floral Art:</b>	Susanne Redpath (M) 0413 138 307
<b>Website Manager</b>	Heather Coleman
<b>MOS Website Address</b>	<a href="http://www.oscov.asn.au/mos">www.oscov.asn.au /mos</a>
<b>MOS Facebook Address</b>	<a href="http://www.facebook.com/maroondahorchidsociety">www.facebook.com/maroondahorchidsociety</a>



## Photos from the Christmas Dinner





## Plants on Display at the Christmas Dinner

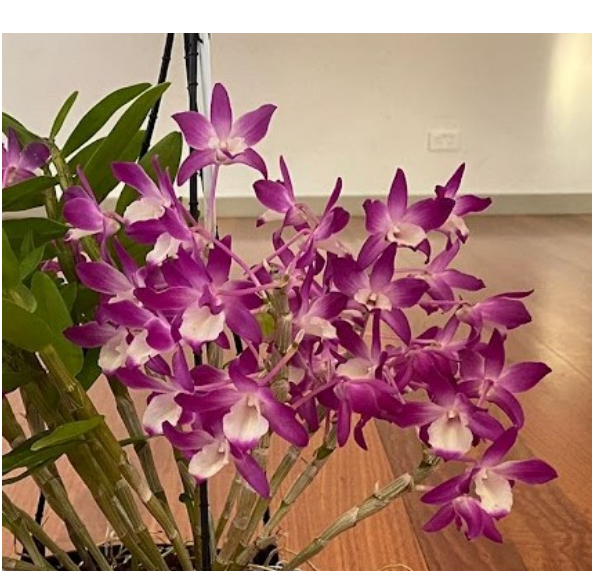



## Plants Flowering Now

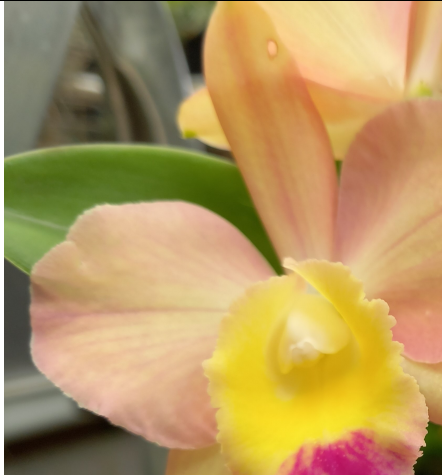

Jim Foster-Johnson's S.C.  
Lana Coryell



Leo Orland's *Maxillaria cucullata*

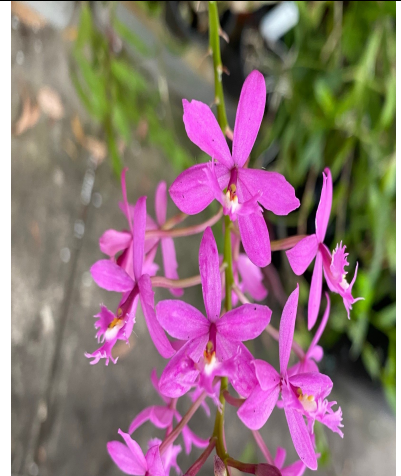

Leo Orland's *Epidendrum*  
Lavender



Leo Orland's *Stanhopea*  
*Nigroviolacea*



Leo Orland's *Laelia stricta*



Leo Orland's  
*Stenoglottis woodii*



Leo Orland's *Coelogyne*  
Mem. W. Micholowitz



Leo Orland's *Coelogyne*  
*Tomentosa*



## **AUTOMATIC SPRINKLERS *versus* HAND WATERING** **by Brian Milligan**

All commercial growers and many large-scale hobby growers use automatic sprinklers to water their orchids and many smaller growers therefore believe that they should do the same as soon as they can afford the cost. But there are pros and cons to both systems, which you should consider before you install an automated watering system.

The obvious advantage of a fully automated sprinkler system is that you can program the computer and theoretically take off for a round-Australia holiday. Unfortunately, it's not quite as simple as that. The optimal frequency of watering is highly dependent on the weather, even when the plants are grown under cover. They become dry very rapidly under warm, windy conditions and may need watering two or three times as frequently under such conditions as they will if the weather is cold and windless. Maybe this isn't so important during the summer months but orchids greatly resent being continually wet during cold, wintry weather, so an automated system with a simple timer is not ideal, especially in winter.

Another disadvantage of sprinkler systems is the difficulty of ensuring even water distribution over all the plants. It's possible to achieve this by judicious placement of the sprinklers but much water is still lost on paths and beyond the boundaries of the growing area. Even then, complete coverage may not be achieved if a strong wind blows from a particular direction.

Hand watering, for preference using a water-breaker spray head (*e.g.* a Damm head), permits each plant to be watered individually and for the water to be directed both over and beneath the leaves, thus ensuring that the compost is thoroughly wet and both the upper and lower surfaces of the leaves are wet (thus, minimising the likelihood of infestation by spider mite, commonly referred to as red spider, which prefer the drier conditions beneath the leaves). Sprinkler systems are seldom effective with large-leafed orchids like lycastes or anguloas, because their leaves very effectively shed most of the water beyond the confines of the pot. Hand-watering is also advantageous at flowering time, because it permits the orchid to be watered without wetting the flowers. Many cymbidium flowers develop unsightly fungal spots if their flowers remain wet for any length of time and so it is best not to water them overhead, especially on still days when the water may take hours to evaporate.

From the above arguments you can see that I strongly favour hand watering. Yes, it takes quite a time to do but at the same time you can



also note those orchid spikes that need staking and detect any insect pests or diseases - just remember to take action when you have finished watering. I have an automated sprinkler system, but use it solely beneath the benches in my glasshouse and masdevallia shade house to maintain a continual high level of humidity.

So why do professional growers use automated sprinkler systems? Solely because it would be hopelessly uneconomic to water all their orchids by hand. Large nurseries take most of the night to water, section by section; they usually water at night, especially in summer, because less water is lost by evaporation then and the mains water pressure is higher at that time.

The big advantage of an automated sprinkler system for the hobbyist comes into play if he or she takes frequent or extended holidays. Fortunately I have several good orchid-growing friends who water my orchids when I go on holidays, a strategy that works well if you are able to reciprocate when they are away. If you ask someone to water your orchids when you go away, try to persuade an orchid grower to do the job. Others with little experience of orchids tend to over-water or else do it each weekend regardless of the weather.

## **LAST THOUGHTs**

**Q.** What do bees say during a heat wave?

**A.** Boy, it's swarm!

**Q.** Why did the robot go on vacation?

**A.** He needed to recharge his batteries.

**Q.** What do you get when you combine an elephant with a fish?

**A.** Swimming trunks.

**Q.** Who's Irish and stays outside all summer?

**A.** Patty O'Furniture.

**Q.** Why don't mummies ever take a summer vacation?

**A.** They're afraid to unwind.

**Q.** Why do bananas use sunscreen?

**A.** So they don't peel.

If Undeliverable Return to:  
The Hon. Secretary,  
Maroondah Orchid Society Incorporated  
P.O.Box 5076, Ringwood. Vic. 3134

## NEWSLETTER



**Collectors Corner/Garden World** - You can get 10% off some items within the store by showing either your membership badge or membership card.

### DISCLAIMER

Maroondah Orchid Society Incorporated, Executive and Committee will not take any responsibility for the results of any action taken on advice given or views expressed by any member or invited speaker at any meeting or show. Views and opinions in this Newsletter by authors of articles do not necessarily reflect the views and opinions of Maroondah Orchid Society Incorporated or its Executive or Committee.